

## PITREAVIE PLAYING FIELDS:

Pitreavie Playing Fields have been developed by the Trustees over a period of nearly forty years. The fine Pavilion includes 21 dressing-rooms, a lounge/dining-room, excellent spray and bath facilities, and a caretaker's house, and represents together with the playing pitches a capital investment by the Trustees before the war of almost £20,000. The Running Track was constructed in 1954 to Olympic standards, with a 440 yard circuit, at a cost of approximately £20,000. In 1961 a handsome Grandstand seating 800 spectators, with changing and ancillary accommodation for athletes and officials, stores and public lavatories, was completed at a cost of approximately £19,000. The whole spacious site extending to about 45 acres is set most attractively between Dunfermline and Rosyth, serviced by regular public transport.

The facilities at Pitreavie, particularly for athletics, are generally reckoned among the finest, if not the finest, in Scotland. The fourteen pitches are well used by local schools, clubs and other groups interested in hockey, football, rugby and cricket. In addition to regular use by the local athletic club, the Olympic Running Track has been made available for the Scottish Schoolgirls' Athletic Championships, the Scottish Women's Amateur Athletic Association Pentathlon, and several other important fixtures, notably the annual match between the Scottish Amateur Athletic Association Select and the Atalanta Club. The Trustees were gratified to learn that the Scottish Women's Amateur Athletic Association had decided to hold their 1963 Championships at Pitreavie in preference to Meadowbank, Edinburgh; this, the growing strength of the local Club (Pitreavie Amateur Athletic Club), and the increasing public interest in athletics in Dunfermline (the larger contests attract over 1,000 spectators) afford some indication of the success which has attended the Trustees' policy of providing in Dunfermline a first-class stadium and of encouraging its use by national as well as local organisations.

The Trustees' total capital expenditure on Pitreavie has been of the order of £60,000, a sum which represents only a fraction of the site's present-day value. At the end of 1962 the

Trustees offered the ground and buildings gratuitously to the County Council upon the following conditions:—

- (1) The Local Education Authority will administer the subjects as Playing Fields only, to be made available on such conditions as they may think reasonable to schools, clubs, and groups of individuals in Dunfermline and District, and to national or other bodies which are concerned with the promotion of sport or athletics.
- (2) In the event of the County Council using or permitting the use of the subjects or any part thereof for purposes other than those envisaged by Condition (1), then, at the discretion of the Trustees, the subjects will revert to the Trustees, subject only to payment to the County Council of such compensation for the then value of approved improvements or additions they may have effected to the lands and buildings, as shall be adjusted with the District Valuer.
- (3) The County Council will have power to erect additional buildings, or alter the existing buildings, provided always that these are utilised only for the purposes of sport or athletics. Before such buildings are erected or altered, plans and specifications will be submitted to the Trustees for prior approval.
- (4) In the event of the County Council deciding to erect any building which is not directly connected with sport or athletics, the site involved in the erection of such building and attached ground shall, at the option of the Trustees, revert to the Trustees free of price, and the County Council shall be bound to grant in their favour an appropriate Conveyance. A price for the site will then be adjusted with the District Valuer, and on payment of that price the Trustees will grant to the County Council a Disposition of the site in normal terms. The plans and specifications of such building will be submitted to the Trustees for prior approval, and no building operations will commence until approval has been given.

- 1962
- (5) The Trustees will reserve the right to define the limits of the area within which any building may be erected.

These conditions were designed to ensure that the magnificent facilities at Pitreavie will continue to provide for the sport and recreation of the people of Dunfermline, and the Trustees have naturally expressed their willingness to assist in the management of the Playing Fields during the transitional period of the transfer of responsibility by accepting representation on an Advisory Committee or other appropriate means.

Earlier in the year the Trustees had instructed the lodging of appeals against the valuation proposed by the County Assessor for the recently-completed Grandstand and the valuation which had earlier been set on the whole area. The first of these appeals was successful, the valuation of the Grandstand being set at £100, a very substantial reduction from the figure originally proposed; but the second appeal was not upheld by the Local Valuation Appeal Committee.

It had been apparent from the first that some protection from the chilly wind which accompanies any special occasion at Pitreavie would have to be incorporated in the Grandstand, and after a year's experience the Trustees decided that it was advisable to provide glass screens extending the full height of the gable ends. This work was carried out in the spring and has achieved a considerable improvement.

Another improvement was the laying out of a three-quarter size football pitch for the use of Wolf Cubs and other smaller players. The desirability of providing such a pitch was brought to the notice of the Trustees by the Dunfermline and District Boy Scouts' Association.

The charges for the use of the facilities at Pitreavie were, in accordance with the Trustees' general policy, doubled during the year, but it was not expected that the clubs would find any difficulty in meeting a charge of 10/- for the use of a pitch, two dressing-rooms, and bathing facilities. The income from lettings has averaged £60 a year for some time; neither this sum nor the additional income expected from the increased charges bears any real relation to the cost of maintaining Pitreavie, which in 1962 amounted to £3,448.

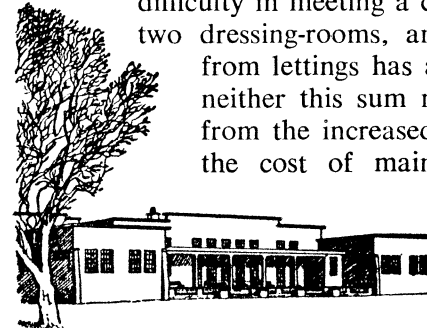

PITREAVIE PLAYING FIELD PAVILION.